

VICINITY MAP - NOT TO SCALE

NOTES:

- OWNER:  
100 VINCENT, LLC  
2 WHARF SIDE APT. 2D  
CHARLESTON, SC 29401  
J.B. DECAMILLA
- PROJECT SUMMARY OF THE STORM SEWER LINE MATERIALS:  
NO. OF NEW SCDOT DROP/GRATE INLETS: 1  
NO. OF NEW SCDOT CURB INLETS: 3  
NO. OF NEW S.T. OUTFALL BOXES: 1  
NO. OF NEW NYOPLAST S.T. INLETS: 2  
NO. OF NEW 18" CPP 45 BENDS: 2  
TOTAL LENGTH OF 18" RCP PIPE: 275 LF  
TOTAL LENGTH OF 15" HP STORM PIPE: 87 LF  
TOTAL LENGTH OF 18" CPP PIPE: 220 LF  
TOTAL LENGTH OF 12" HP STORM PIPE: 15 LF  
TOTAL LENGTH OF 8" HDPE PIPE: 445 LF
- CONTRACTOR RESPONSIBLE FOR THE WATER LINE INSTALLATION:  
JAMES WHITE CONSTRUCTION  
7251 CROSSPARK DR.  
N. CHARLESTON, SC 29418
- DATE OF COMPLETION:  
JULY, 2016

REFERENCES:

- ENGINEERING PLANS AND CAD DRAWING FROM EARTHSOURCE ENGINEERING UNDER JOB NO. 14-142 & DATED 6-15-2014.

AS-BUILT NOTES:

- THIS AS-BUILT REPRESENTS A SURVEY BASED UPON THE LISTED REFERENCES ONLY, AND IS NOT THE RESULT OF A TITLE SEARCH.
- THE BEARINGS SHOWN HEREON ARE BASED ON SC SPC ZONE 3900 (NAD '83).
- AREA DETERMINED BY COORDINATE METHOD.
- THE SURVEY SHOWS EASMENTS WHICH ARE OBVIOUS OR APPARENT TO THE SURVEYOR, AT THE TIME OF THE SURVEY.
- UNDER GROUND TEES, BENDS, SLEEVES, ETC., ARE SHOWN ACCORDING TO MARKS ON THE GROUND AS PROVIDED BY THE UTILITY CONTRACTOR AND BY THEIR REVIEW OF THIS AS-BUILT. AN ACTUAL SURVEY OF BELOW GROUND UTILITIES WAS NOT PERFORMED. JBR CONSTRUCTION SERVICES, LLC, TAKES NO RESPONSIBILITY FOR THE ACTUAL LOCATION OR DIRECTION OF THIS UTILITY LINE BELOW THE SURFACE LEVEL.
- ELEVATIONS ARE BASED ON NGVD 1929 DATUM.

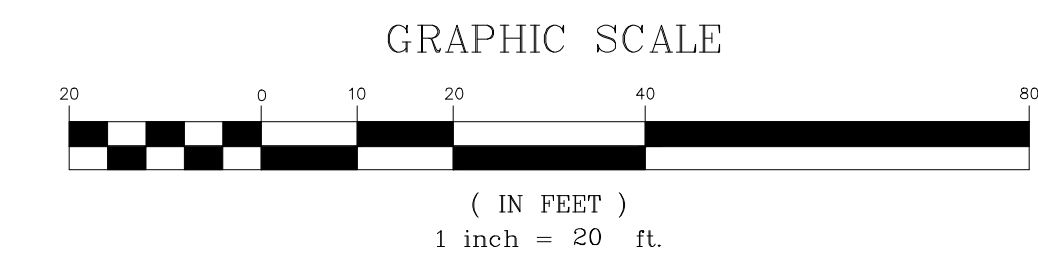
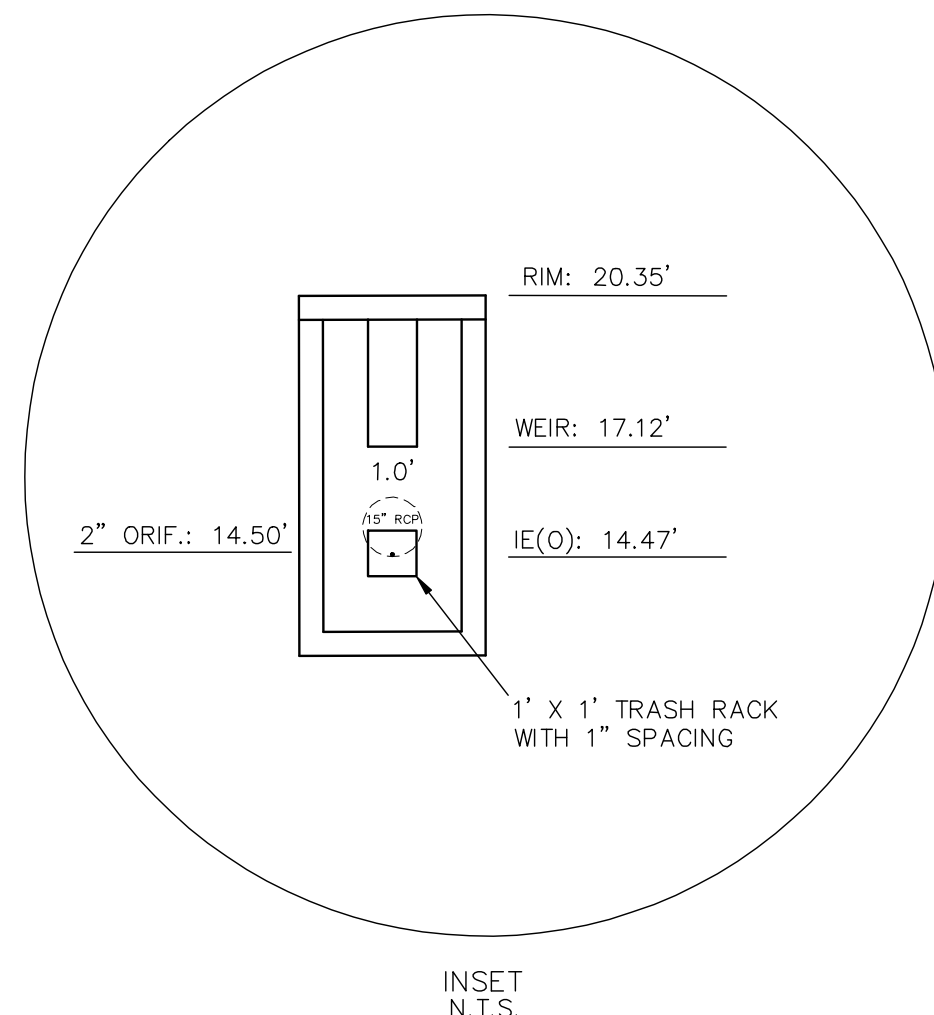
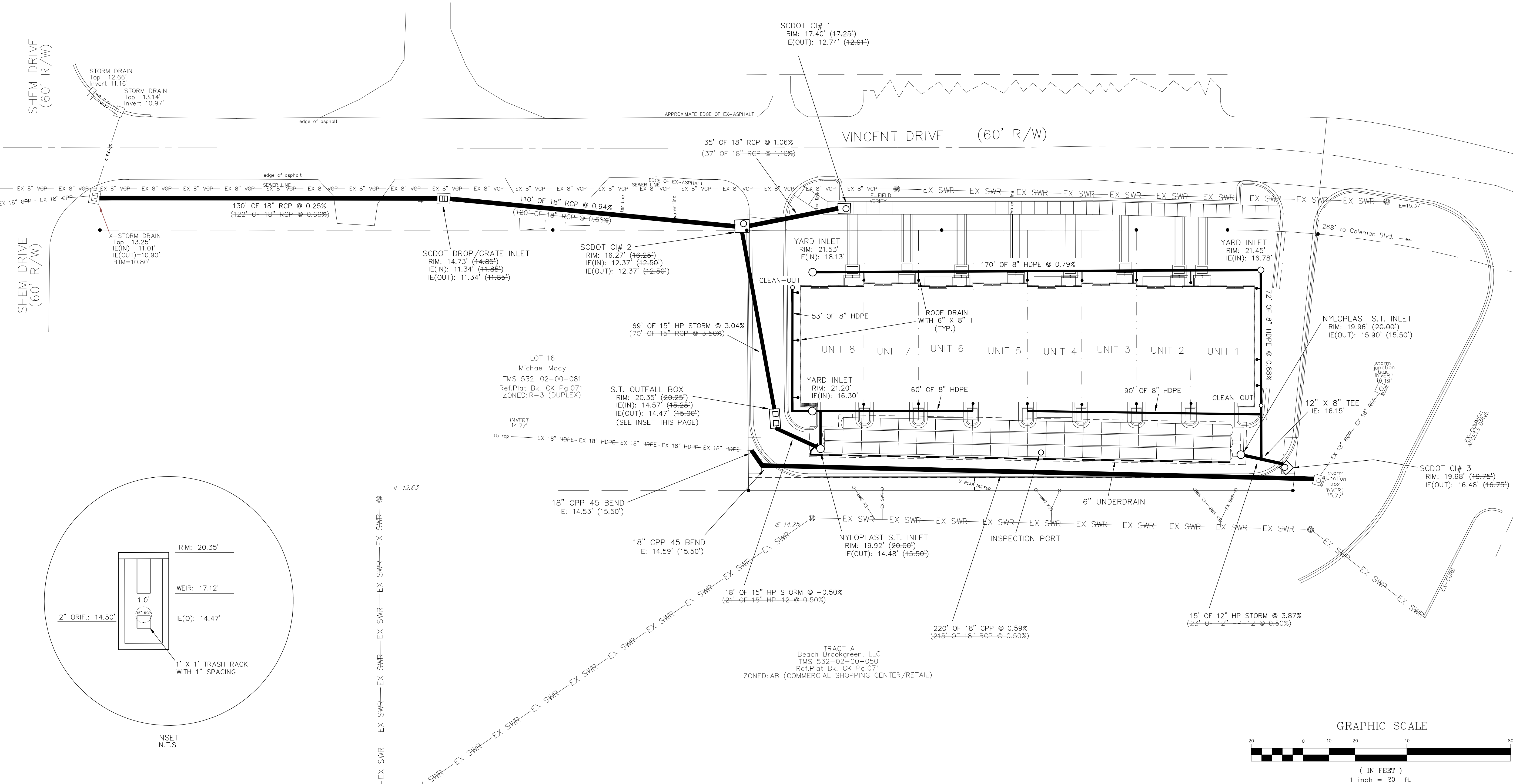

I HAVE EXAMINED THESE PLANS & SPECIFICATIONS AND HEREBY SIGN, DATE, & AFFIX MY SEAL TO CERTIFY TO THE BEST OF MY KNOWLEDGE THAT THE STORM WATER MANAGEMENT FACILITIES SHOWN ON THE AS-BUILT/RECORD DRAWINGS WERE CONSTRUCTED SUBSTANTIALLY ACCORDING TO THE APPROVED PLANS. ANY DEVIATIONS BETWEEN THE AS-BUILT/RECORD DRAWINGS AND THE PLANS AND SPECIFICATIONS HAVE BEEN NOTED ON THE AS-BUILT/RECORD DRAWINGS AND WILL NOT ADVERSELY IMPACT THE OPERATION, CAPACITY, OR CAPABILITY OF THE SYSTEM.

GILES N. BRANCH  
SC PLE# 26148

I HEREBY STATE TO THE BEST OF MY PROFESSIONAL KNOWLEDGE, INFORMATION, AND BELIEF, THE SURVEY SHOWN HEREIN WAS MADE IN ACCORDANCE WITH THE REQUIREMENTS OF THE STANDARDS OF PRACTICE MANUAL IN SOUTH CAROLINA AND MEETS OR EXCEEDS THE REQUIREMENTS OF A CLASS A SURVEY AS SPECIFIED THEREIN. ALSO, THERE ARE NO VISIBLE ENCROACHMENTS OR PROJECTIONS OTHER THAN SHOWN.

JOEL B. RUSSELL  
106 MACY CIRCLE  
GOOSE CREEK, SC 29445  
843-296-4448

SC PLS# 28140  
843-296-4448

TRACT A  
Beach Brookgreen, LLC  
TMS 532-02-00-050  
Ref.Plat Bk. CK Pg.071  
ZONED: AB (COMMERCIAL SHOPPING CENTER/RETAIL)

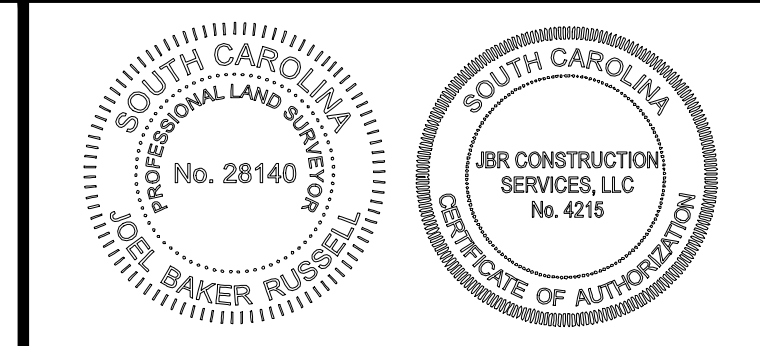

**JBR CONSTRUCTION SERVICES, LLC**  
JOEL B. RUSSELL  
SPLS  
1st In Construction Staking

106 MACY CIRCLE  
GOOSE CREEK, SC 29445  
Cell: 843-296-4448  
Fax: 843-640-3350  
E-Mail: jbr@jbrconstruction.com

SCALE	DATE
1"=20'	SEPTEMBER 8, 2016
FLD. BK.	PG.
DATA COLLECTOR	JBR
JOB NO.	CHECKED BY
216-0039	JBR

TITLE: VINCENT DRIVE TOWN HOMES  
100 VINCENT DR.  
MT. PLEASANT, SC 29464

CHARLESTON COUNTY SOUTH CAROLINA

STORM WATER RECORD DRAWING

SHEET 1 OF 1